

Installation Guide

Chroma-Q® 2inspire™ BARNDOOR KIT

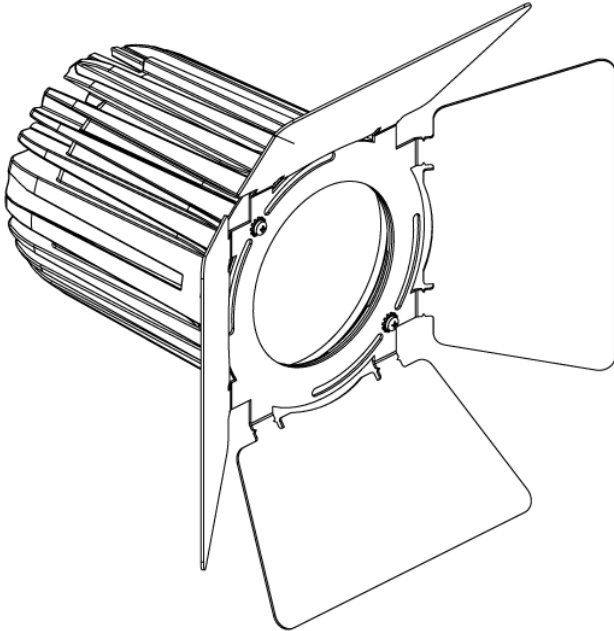

Chroma-Q®
BRILLIANT SOLUTIONS

For a full product manual please visit www.chroma-q.com

For use with

Part Number: CQ1509-9141, CQ1509-9142,
CQ1509-9241, CQ1509-9242,
CQ1509-9341, CQ1509-9342.

Model: 1509-9141, 1509-9142, 1509-9241, 1509-9242
1509-9341, 1509-9342

Items in the Kit:

Description	2inspire 100		2inspire 200		2inspire 300		QTY
	Black (1509-9141)	White (1509-9142)	Black (1509-9241)	White (1509-9242)	Black (1509-9341)	White (1509-9342)	
Barn Door	1509-0001	1509-0002	1509-0006	1509-0007	1509-0011	1509-0012	1
Screw	4251-2160	4251-2162	4301-2160	4301-2162	4301-2160	4301-2162	2
Washer	430-2606-4						2

1. Tools Required

- 3 mm Allen key
- 2.5 mm Allen key
- Phillip Head screw driver

2. Installation Procedure (in Sequence)

1. Unscrew the 2 diagonal respective screws
2. Depending on the application for barndoor:
 - i) Static: Align holes of barndoor with holes on the fixture as shown in the figure below
 - ii) Rotation: Align slots of barndoor with holes on the fixture to facilitate rotation of barndoor.
3. Assemble barndoor with washer and screw.

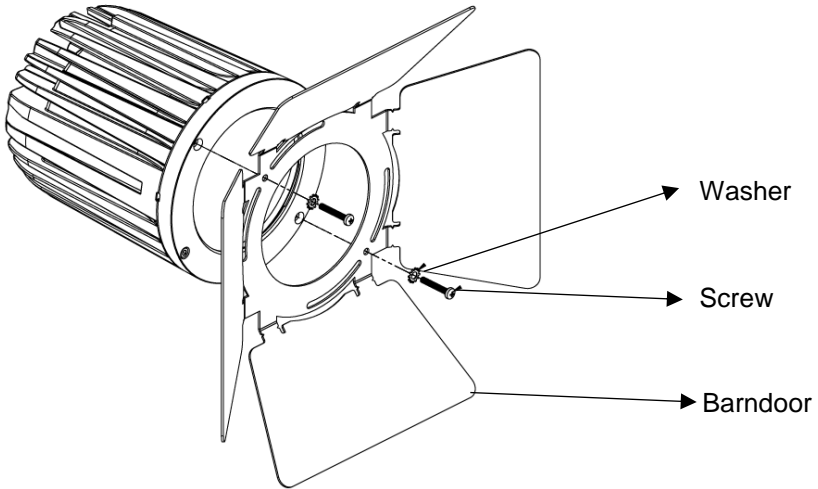

****Refer to the table (Items in the kit) to identify the part numbers**

4. Line drawings in Metric:

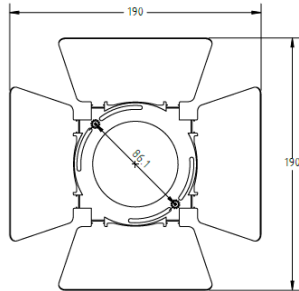
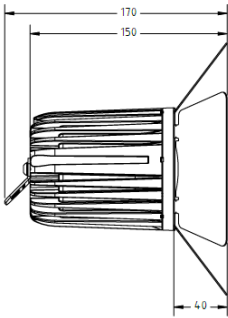

1501 Model – Halfway Open

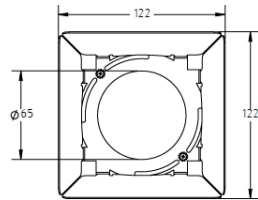
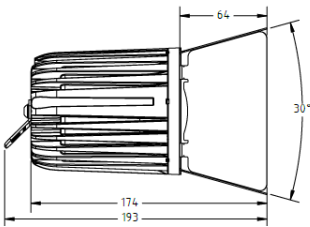

1501 Model – Fully Closed

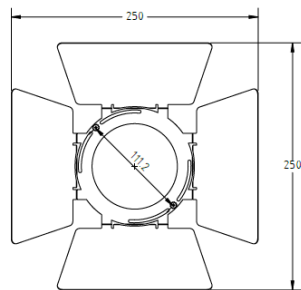
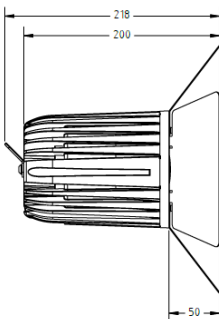

1502 Model – Halfway Open

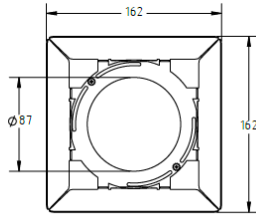
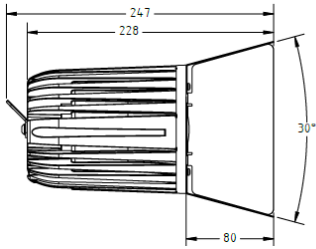

1502 Model – Fully Closed

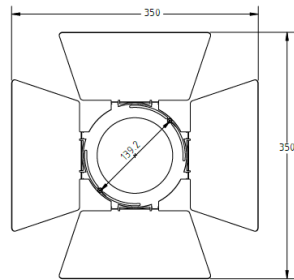
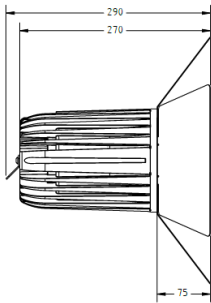

1503 Model – Halfway Open

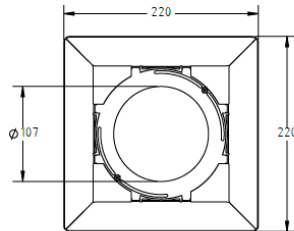
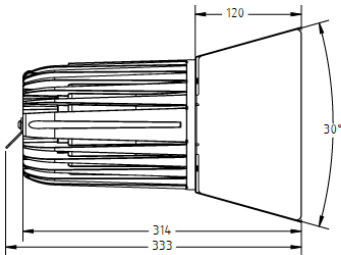

1503 Model – Fully Closed

Disclaimer

Dimensions and illustrative drawings contained herein are accurate to the company's knowledge at the time of printing, however specifications are subject to change without notice.

Further Information

Please refer to the Chroma-Q 2inspire™ Manual for more detailed information about the fixture. A copy of the manual can be found at the Chroma-Q website – <http://www.chroma-q.com/support/downloads.asp>

Approvals & Disclaimer



The information contained herein is offered in good faith and is believed to be accurate. However, because conditions and methods of use of our products are beyond our control, this information should not be used in substitution for customer's tests to ensure that Chroma-Q products are safe, effective, and fully satisfactory for the intended end use. Suggestions of use shall not be taken as inducements to infringe any patent. Chroma-Q sole warranty is that the product will meet the Chroma-Q sales specifications in effect at the time of shipment. Your exclusive remedy for breach of such warranty is limited to refund of purchase price or replacement of any product shown to be other than as warranted.

Chroma-Q reserves the right to change or make alteration to devices and their functionality without notice due to on-going research and development.

The Chroma-Q 2inspire™ has been designed specifically for the lighting industry. Regular maintenance should be performed to ensure that the products perform well in the entertainment environment.

If you experience any difficulties with any Chroma-Q products please contact your selling dealer. If your selling dealer is unable to help please contact support@chroma-q.com. If the selling dealer is unable to satisfy your servicing needs, please contact the following for full factory service:

Outside North America: North America:
Tel: +44 (0)1494 446000 Tel: +1 416-255-9494
Fax: +44 (0)1494 461024 Fax: +1 416-255-3514
support@chroma-q.com support@chroma-q.com

For further information please visit the Chroma-Q website at www.chroma-com.

Chroma-Q is a trademark, for more information on this visit www.chroma-q.com/trademarks.

The rights and ownership of all trademarks are recognized.